

AVAILABLE FOR
PURCHASE



All Smoke

24.00m (78'8"ft) | Southern Wind Shipyard | 2004

Purchase S/Y All Smoke

Built in 2004, All Smoke is the fourth hull of the 78' miniseries, one of the most successful Southern Wind projects, that boast the design partnership of Reichel Pugh Design and Nauta Design.

Price

2 100 000 €

Details correct as of 14 Mar, 2019

FOR SALE

Cabins: 3
Guests: 8
Crew: 4
Beam: 5.91m (19'4"ft)
Draft: -
Speed: -
Built/Refit: 2004

View online at

<http://www.superyachts.com/luxury-yacht-for-sale/all-smoke-2783/>

PLEASE CALL TO ENQUIRE:

HK Tel: +852 81 237 983 
UK Tel: +44 20 8123 0667 
USA Tel: +1 239 243 9678 

FOR MORE INFORMATION VISIT [SUPERYACHTS.COM](http://www.SUPERYACHTS.COM)

ALL SMOKE

24.00m (78'8"ft) | 2004

DESCRIPTION

Thanks to the Reichel Pugh naval architecture, All Smoke features slippery hull' lines, a fin and bulb keel, a high aspect ratio and balanced rudder.

The general concept, the interior layout and the exterior styling are drawn by the Italian designers Nauta Design. While the UKbased SP Technologies are responsible for the composite structural engineering of the hull, decks and structures, which are made in sandwich (Carbon fibres and Kevlar) with epoxy resin.

The result is an exceedingly well rounded yacht of excellent performance, whose building philosophy calls for straightforward, simple sailing systems, free from unnecessary technology.

All Smoke is a real cruiser/racer, ideal both for bluewater cruises and competitive races. She enjoys an excellent reputation in the racing field, thanks to remarkable results of major races such as the Maxi Rolex Cup (Winner of 2005 Palma Superyacht Cup, first in the Mini Maxi IRC class in 2007 edition and winner of Mini Maxi Rolex World Championship Cup in 2011 edition). A versatile deck plan incorporates a large guest cockpit protected by a recessed dodger, a generous sunbed area and a separated sailing cockpit with dual steering wheels.

A new teak has been applied on deck, appraising the yacht clean an flash lines, on spring 2014.

All Smoke has an interior configuration ideal for Cruising and for Charter, featuring a separation between the owner/guest area (forward) and the crew mess (aft). The access below deck is gained either through the aft or the guest cockpit companion-ways. The stairway of the latter leads to the saloon which makes use of the full beam of the yacht. This area accommodates an 8/10 dining table, a comfortable conversation area and luxury accessories including a refrigerator, an icemaker and a wine cooler.

All Smoke's interior follows Southern Wind Shipyard's most popular layout, with the owner's cabin forward: although it is the narrowest area on the boat, it still has abundant room for two separate bunks (one double and one single bunk), storage spaces and an ensuite bathroom. This cabin layout allows privacy and comfort also when sailing.

The same attention for privacy and comfort that are used in the master cabin are found throughout the entire yacht. The layout All Smoke includes two guest cabins amidships: a twin cabin with additional Pullman bunk and a double bunk cabin; they both enjoy an en-suite head.

All guest cabins are conceived for functionality and the furniture is built in sturdy yet lightweight honeycomb sandwich veneered with natural teak.

The direct access to sailing cockpit from the crew quarters, is granted through the aft companion-way. Here the functional galley and the nav station are linked to a pair of crew cabins with shared head forward, so that the crew and the galley area are effectively separated from the owner's party.

The engine room access is conveniently located in the corridor which leads to the crew quarters.

MAINTENANCE HISTORY

ACCURATE REFIT
Having had one owner only, All Smoke stands out for her stunning conditions, thanks to a highly motivated European crew, with a 12-years experience on board of this yacht. The boat carried out a series of accurate refits:
HULL

- 2015 Hull sides paint

DECK

- 2013 New dodger and spray hood
- 2013 New mainsail traveller track
- 2014 Anchor chain
- 2014 New windlass
- 2015 New hatches
- 2015 Super structure paint
- 2015 New teak on deck

INTERIORS

- 2011 New shower gratings
- 2013 Floorboards all revarnished
- 2014 Port cabin head overhaul (paintjob and woodwork)

MACHINERY & SYSTEMS

- 2011 New led lights thought the whole yacht
- 2012 New Air Con (marine air system) with new gas 407
- 2013 New propeller 4 blade varifold bruntons (for cruising)
- 2013 New propeller 3 blade with overdrive gori (for racing)
- 2013 New batteries
- 2013 New water maker pump and new membranes
- 2014 New engine shaft
- 2014 New chargers and inverters
- 2015 Engine blower
- 2015 Engine: new heat exchanger
- 2015 New generator
- 2015 New fridge compressors, new concept 220 vac on inverter
- 2015 New bilge pump, new fresh water pump, a/c pump

ELECTRONIC & ENTERTAINMENT

- 2008 New satellite bb250
- 2012 Electronics: new b&g h3000
- 2012 Electronics: new pc mac, new simrad plotter, new vhf
- 2012 Entertainment: new bose system, tv, playstation

RIGGING

- 2003 Spectra staysail north sails
- 2003 Spectra genoa north sails
- 2003 Spectra main sail north sails
- 2010 Main sail north sail (3dl marathon with taffetta)
- 2012 Genoa north sail (3dl

PLEASE CALL TO ENQUIRE:

HK Tel: +852 81 237 983 
UK Tel: +44 20 8123 0667 
USA Tel: +1 239 243 9678 

FOR MORE INFORMATION VISIT SUPERYACHTS.COM

overhaul

- 2015 Full overhaul check and ultrasound on all Carbon fittings on rigging and deck report Available
- 2015 Point of rigging (mast and boom)

ALL SMOKE

24.00m (78'8"ft) | 2004

YACHT LAYOUT

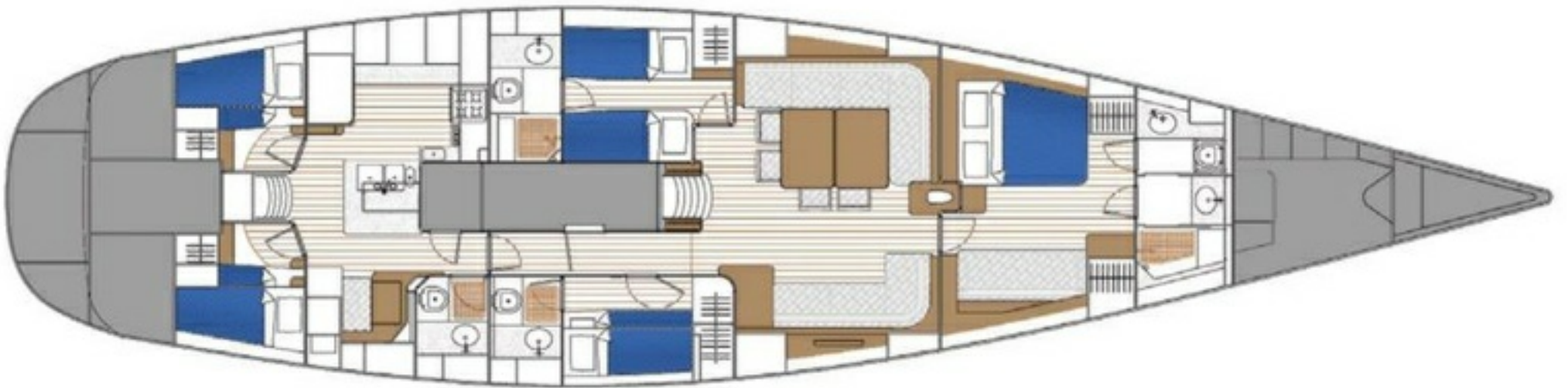

PLEASE CALL TO ENQUIRE:

HK Tel: +852 81 237 983 

UK Tel: +44 20 8123 0667 

USA Tel: +1 239 243 9678 

FOR MORE INFORMATION VISIT [SUPERYACHTS.COM](https://www.superyachts.com)

ALL SMOKE

24.00m (78'8"ft) | 2004



PLEASE CALL TO ENQUIRE:

HK Tel: +852 81 237 983 
UK Tel: +44 20 8123 0667 
USA Tel: +1 239 243 9678 

FOR MORE INFORMATION VISIT SUPERYACHTS.COM

ALL SMOKE

24.00m (78'8"ft) | 2004



PLEASE CALL TO ENQUIRE:

HK Tel: +852 81 237 983 
UK Tel: +44 20 8123 0667 
USA Tel: +1 239 243 9678 

FOR MORE INFORMATION VISIT SUPERYACHTS.COM

ALL SMOKE

24.00m (78'8"ft) | 2004

SPECIFICATIONS

Overview

Name:	All Smoke
Type:	Sail Yacht
Model:	Custom
Sub Type:	Racing/Cruising
Builder:	Southern Wind Shipyard
Naval Architect:	Reichel Pugh Yacht Design
Exterior Designers:	Nauta Design
Interior Designer:	Nauta Design
Year:	2004
Flag:	Malta
MCA:	
Class:	CE certificate No. DIP502500/XE - Pleasure Craft
Hull NB:	-
Hull Colour:	-

Dimensions

Length Overall:	24.00m (78'8"ft)
Length at Waterline:	-
Beam:	5.91m (19'4"ft)
Draft (min):	3.80m (12'5"ft)
Draft (max):	-
Gross Tonnage:	-

Accommodations

Guests:	8
Cabins Total:	3
Cabins:	-
Crew:	4

Construction

Hull Configuration:	Fin & Bulb
Hull Material:	Composite
Superstructure:	-
Deck Material:	Teak
Decks NB:	-

Engine(s)

Total Power:	- / -
Propulsion:	-

Performance & Capabilities

Max Speed:	-
Cruising Speed:	-
Range:	-
Fuel Capacity:	-
Water Capacity:	-

Equipment

Generator:	-
Stabilizers:	-
Thrusters:	-
Amenities:	-

PLEASE CALL TO ENQUIRE:

HK Tel: +852 81 237 983 
UK Tel: +44 20 8123 0667 
USA Tel: +1 239 243 9678 

FOR MORE INFORMATION VISIT [SUPERYACHTS.COM](https://www.superyachts.com)