

AVAILABLE FOR  
PURCHASE



# Avella

33.50m (109'10"ft) | Azimut Yachts | 1991

## Purchase M/Y Avella

Avella is a 33.50 metre motor yacht which was built and launched by the Italian yacht builder Azimut in 1991.

### Price

795 000 €

Details correct as of 27 Sep, 2020

## FOR SALE

Cabins: 4  
Guests: 8  
Crew: 6  
Beam: 7.01m (22'11"ft)  
Draft: 2.11m (6'11"ft)  
Speed: 14.00 kts  
Built/Refit: 1991 / 2013

View online at

<http://www.superyachts.com/luxury-yacht-for-sale/avella-2931/>

# AVELLA

33.50m (109'10"ft) | 1991

---

## DESCRIPTION

Full interior and exterior refit in 2013, AVELLA offers luxurious surroundings in a beautifully maintained motor yacht. Her warm wood interior creates a cozy atmosphere. However, choice is not limited, AVELLA's large flybridge offers an open air comfortable cruise and relaxation area. An option of al fresco dining both on the flybridge and aft deck, or enjoy a more formal atmosphere in the interior dining room.

---

## ACCOMMODATION

Avella can sleep up to a maximum of ten guests in her four stateroom layout which features a master cabin and three guest cabins. She also fully accommodates for her crew in separate crew quarters.

# AVELLA

33.50m (109'10"ft) | 1991

## YACHT LAYOUT



Lower Deck

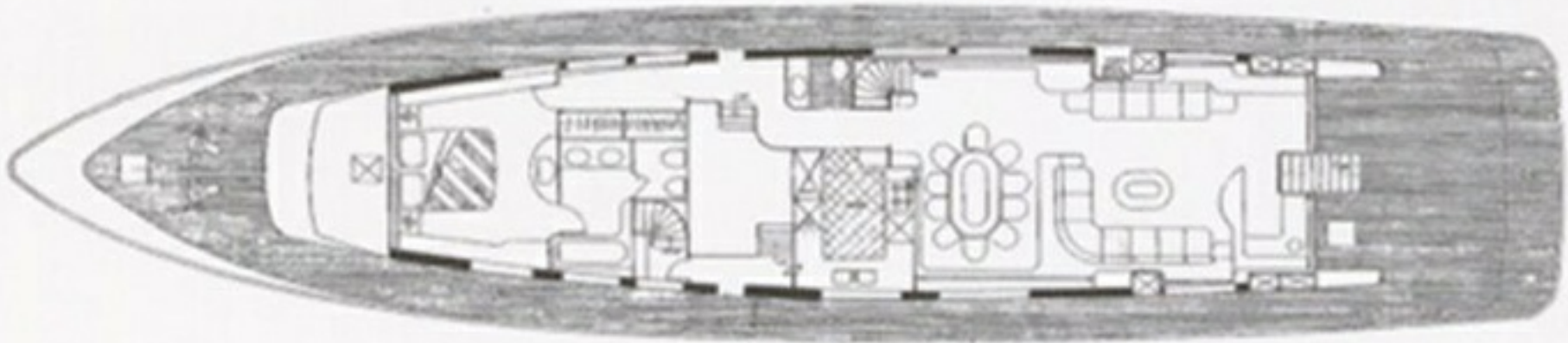

Main Deck

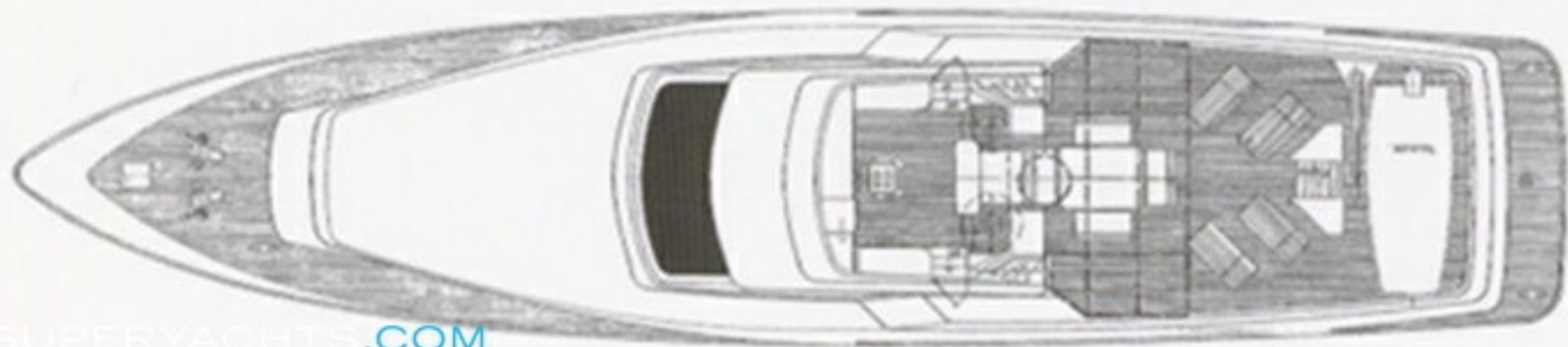

Sun Deck

[SUPERYACHTS.COM](http://SUPERYACHTS.COM)

# AVELLA

33.50m (109'10"ft) | 1991

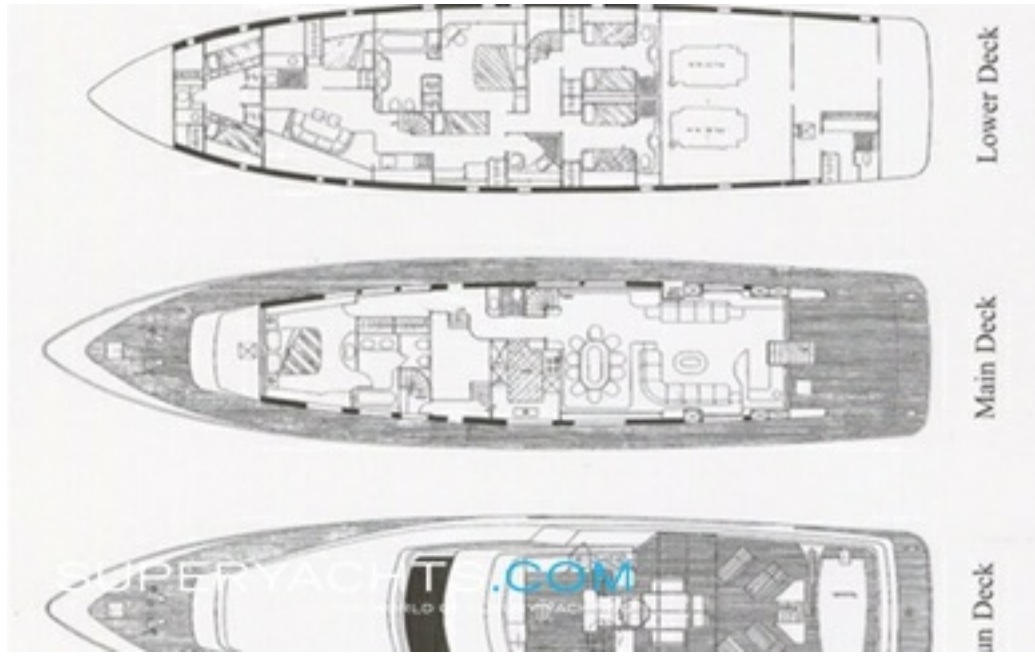

FOR MORE INFORMATION VISIT [SUPERYACHTS.COM](http://SUPERYACHTS.COM)

# AVELLA

33.50m (109'10"ft) | 1991



# AVELLA

33.50m (109'10"ft) | 1991



# AVELLA

33.50m (109'10"ft) | 1991

## SPECIFICATIONS

### Overview

Name:	Avella
Type:	Motor Yacht
Model:	Custom
Sub Type:	
Builder:	Azimut Yachts
Naval Architect:	Ugo Costaguta <a href="#">Terence Disdale</a>
Exterior Designers:	Stefano Natucci
Interior Designer:	<a href="#">Terence Disdale</a>
Year:	1991
Flag:	Cayman Islands
MCA:	Yes
Class:	-
Hull NB:	105/16
Hull Colour:	-

### Dimensions

Length Overall:	33.50m (109'10"ft)
Length at Waterline:	26.50m (86'11"ft)
Beam:	7.01m (22'11"ft)
Draft (min):	-
Draft (max):	2.11m (6'11"ft)
Gross Tonnage:	167 tonnes

### Accommodations

Guests:	8
Cabins Total:	4
Cabins:	-
Crew:	6

### Construction

Hull Configuration:	-
Hull Material:	GRP
Superstructure:	GRP
Deck Material:	Teak
Decks NB:	-

### Engine(s)

Quantity:	2
Fuel Type:	Diesel
Manufacturer:	MTU
Model:	12V 396 TB93
Power:	2000hp / 1442kW
Total Power:	4000hp / 2884kW
Propulsion:	Twin Screw

### Performance & Capabilities

Max Speed:	25.00 kts
Cruising Speed:	14.00 kts
Range:	600.00 miles at 18 kts
Fuel Capacity:	12,000.00 L / 2,639.63 USG
Water Capacity:	2,275.00 L / 500.43 USG

### Equipment

Generator:	2 x - 45 kW
Stabilizers:	-
Thrusters:	-
Amenities:	-