

AVAILABLE FOR
CHARTER



Callisto

24.38m (79'11"ft) | Nautor's Swan | 1995

Callisto

Callisto is a 24.38 metre sloop rigged sailing yacht which was built and launched by Finland's Nautor's Swan shipyard in 1995. She has recently been refitted in 2010 meaning she has been fully modernised and is in pristine condition.

Weekly Charter Rates

Summer

From 23 800 €

Winter

From 23 800 €

Details correct as of 19 Apr, 2019

FOR CHARTER

Cabins: 3
Guests: 6
Crew: 4
Beam: 7.54m (24'8"ft)
Draft: 3.73m (12'2"ft)
Speed: 9.00 kts
Built/Refit: 1995 / 2010

View online at

<http://www.superyachts.com/yacht-charter/callisto-1751/>

PLEASE CALL TO ENQUIRE:

HK Tel: +852 81 237 983 
UK Tel: +44 20 8123 0667 
USA Tel: +1 239 243 9678 

FOR MORE INFORMATION VISIT [SUPERYACHTS.COM](http://www.SUPERYACHTS.COM)

CALLISTO

24.38m (79'11"ft) | 1995

DESCRIPTION

Characterised by design style, sailing performance and luxurious comfort, it is an impressive yacht capable of delivering a thrilling sailing experience like no other. On Callistó, speed, safety and manoeuvr-ability compete with technology, craftsmanship and versatility.

Her rig is the epitome of yachting technology. Her sail controls are fully computerized. Her hatches, fittings and genoa tracks are recessed flush into the teak deck. On the upper deck, the forward cockpit con- verts to a dining area for eight, complete with Hi/Fi audio.

Once you climb down to the lower deck, you instantly recognise why Callistó is in a class of her own. Finished in polished teak throughout, her great style flirts with elegance and comfort. The full-beam salon is furnished in comfortable blue leather and has home cinema and audio/visual entertainment equipment, a library and communication facilities. The spacious dining area for eight, is supported by a fully enclosed galley. Callistó can accommodate six guests in one Master Cabin and two Cabins.

Last but not least, the Callistó crew is a team of professionals who take pride in what they do and how. They are on board to serve and to assist you. You will find them experienced, courteous and discreet. Sailing apart, there is plenty to do on board Callistü. Enjoy the shade of a Bimini when riding at anchor. Sunbathe while cruising under power at up to 10 knots. Read a thriller, sip appetizing aperitifs, in-dulge in deliciously fresh cuisine from our award- winning chef, dance to Greek music!

Swim in truly crystal-clear waters in secluded alcoves - they still exist! Lunch on fish that tastes of sea! Take an afternoon siesta. Let go with a glass of ouzo on the rocks or share a perfectly chilled bottle of champagne! Finish your day catching shooting stars with your eyes...

TENDER & TOYS

Zodiac Rib inflatable with 25 hp outboard

Snorkelling equipment

Tubes, banana

Fishing equipment

PLEASE CALL TO ENQUIRE:

HK Tel: +852 81 237 983 

UK Tel: +44 20 8123 0667 

USA Tel: +1 239 243 9678 

FOR MORE INFORMATION VISIT [SUPERYACHTS.COM](https://www.superyachts.com)

CALLISTO

24.38m (79'11"ft) | 1995

YACHT LAYOUT

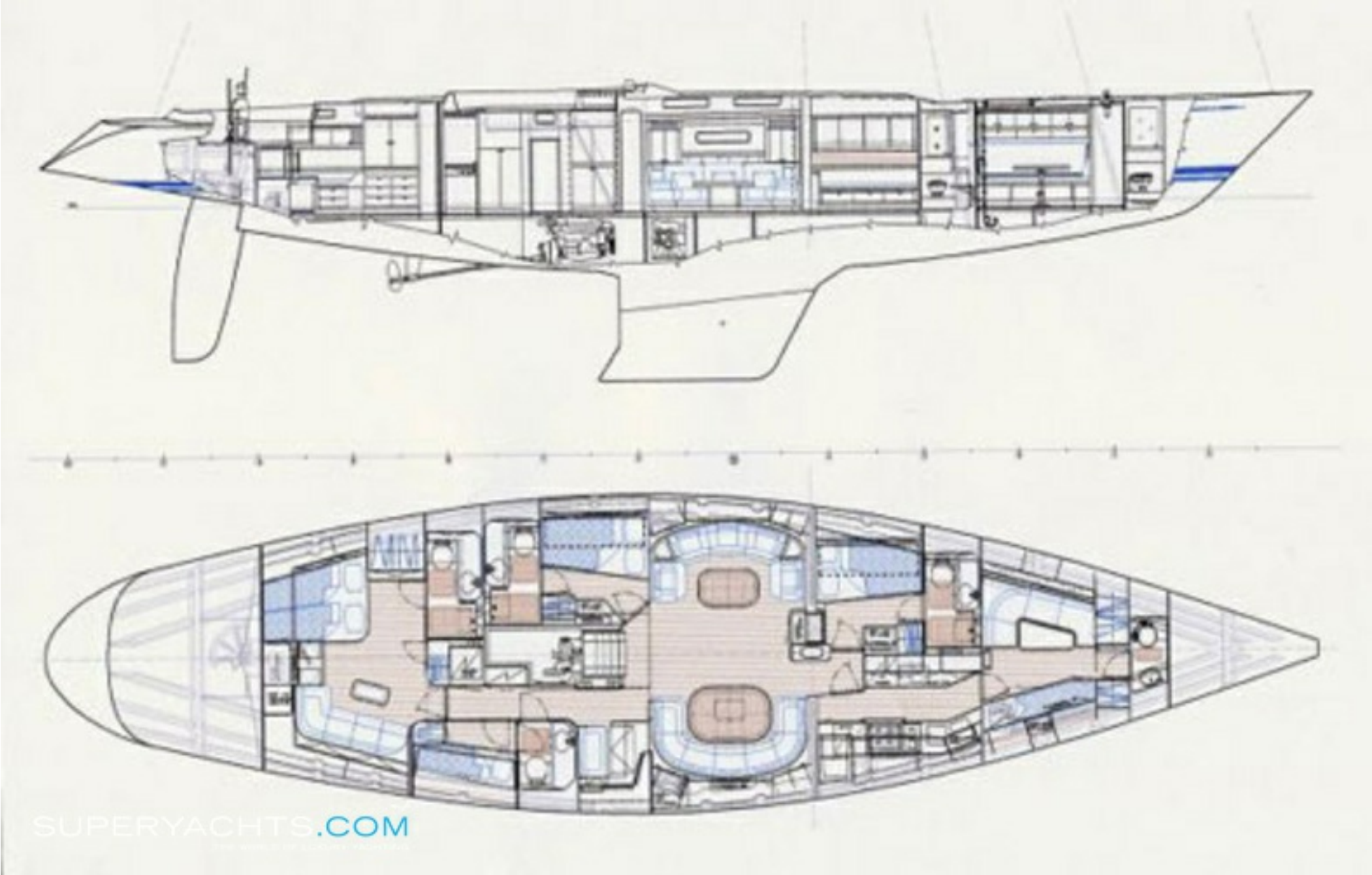

PLEASE CALL TO ENQUIRE:

HK Tel: +852 81 237 983 
UK Tel: +44 20 8123 0667 
USA Tel: +1 239 243 9678 

FOR MORE INFORMATION VISIT [SUPERYACHTS.COM](https://www.superyachts.com)

CALLISTO

24.38m (79'11"ft) | 1995



PLEASE CALL TO ENQUIRE:

HK Tel: +852 81 237 983 

UK Tel: +44 20 8123 0667 

USA Tel: +1 239 243 9678 

FOR MORE INFORMATION VISIT SUPERYACHTS.COM

CALLISTO

24.38m (79'11"ft) | 1995



PLEASE CALL TO ENQUIRE:

HK Tel: +852 81 237 983 
UK Tel: +44 20 8123 0667 
USA Tel: +1 239 243 9678 

FOR MORE INFORMATION VISIT SUPERYACHTS.COM

CALLISTO

24.38m (79'11"ft) | 1995

SPECIFICATIONS

Overview

| | |
|---------------------|---------------|
| Name: | Callisto |
| Type: | Sail Yacht |
| Model: | Custom |
| Sub Type: | |
| Builder: | Nautor's Swan |
| Naval Architect: | German Frers |
| Exterior Designers: | German Frers |
| Interior Designer: | |
| Year: | 1995 |
| Flag: | Greek |
| MCA: | |
| Class: | - |
| Hull NB: | - |
| Hull Colour: | - |

Dimensions

| | |
|----------------------|-------------------|
| Length Overall: | 24.38m (79'11"ft) |
| Length at Waterline: | - |
| Beam: | 7.54m (24'8"ft) |
| Draft (min): | - |
| Draft (max): | 3.73m (12'2"ft) |
| Gross Tonnage: | - |

Accommodations

| | |
|---------------|---------------------------------|
| Guests: | 6 |
| Cabins Total: | 3 |
| Cabins: | 1 Double / 2 Twin / 2 Pullman / |
| Crew: | 4 |

Construction

| | |
|---------------------|------|
| Hull Configuration: | - |
| Hull Material: | GRP |
| Superstructure: | - |
| Deck Material: | Teak |
| Decks NB: | - |

Engine(s)

| | |
|---------------|---------------|
| Quantity: | 1 |
| Fuel Type: | Diesel |
| Manufacturer: | Perkins |
| Model: | - |
| Power: | 225hp / 168kW |
| Total Power: | 225hp / 168kW |
| Propulsion: | - |

Performance & Capabilities

| | |
|-----------------|----------|
| Max Speed: | - |
| Cruising Speed: | 9.00 kts |
| Range: | - |
| Fuel Capacity: | - |
| Water Capacity: | - |

Equipment

| | |
|--------------|---|
| Generator: | - |
| Stabilizers: | - |
| Thrusters: | - |
| Amenities: | - |

PLEASE CALL TO ENQUIRE:

HK Tel: +852 81 237 983 
UK Tel: +44 20 8123 0667 
USA Tel: +1 239 243 9678 

FOR MORE INFORMATION VISIT [SUPERYACHTS.COM](https://www.superyachts.com)