

AVAILABLE FOR
PURCHASE



Papa Joe

33.80m (110'10"ft) | Mastori Yachts | 2007

Luxury Yacht Papa Joe For Sale

This sailing yacht Papa Joe is a 34 metre well sized steel vessel which was fashioned by Mastori Yachts.

Price

3 300 000 €

Details correct as of 05 Mar, 2019

FOR SALE

Cabins: 5
Guests: 10
Crew: 6
Beam: 8.20m (26'10"ft)
Draft: 4.80m (15'8"ft)
Speed: 12.00 kts
Built/Refit: 2007

View online at

<http://www.superyachts.com/luxury-yacht-for-sale/papa-joe-1068/>

PLEASE CALL TO ENQUIRE:

HK Tel: +852 81 237 983 
UK Tel: +44 20 8123 0667 
USA Tel: +1 239 243 9678 

FOR MORE INFORMATION VISIT [SUPERYACHTS.COM](http://www.SUPERYACHTS.COM)

PAPA JOE

33.80m (110'10"ft) | 2007

DESCRIPTION

Combining sophisticated design, first-class seakeeping and exceptional service, Papa Joe provides the last word in comfortable cruising.

ACCOMMODATION

Papa Joe can accommodate 10 guests in 1 master suite & 4 double cabins

COMMUNICATION

Wi-fi internet
Simrad radar
Simrad GPS
VHF
Seatel Sat TV

AUDIO & VISUAL EQUIPMENT

42" plasma TV in master suite and salon with DVD player
Satellite TV system
27" plasma TV with DVD in each cabin.
BOSE indoor and outdoor music system

TENDER & TOYS

Water ski, ringo, snorkelling, canoeing, windsurf, wakeboard and mono board

PLEASE CALL TO ENQUIRE:

HK Tel: +852 81 237 983 
UK Tel: +44 20 8123 0667 
USA Tel: +1 239 243 9678 

FOR MORE INFORMATION VISIT SUPERYACHTS.COM

PAPA JOE

33.80m (110'10"ft) | 2007

YACHT LAYOUT

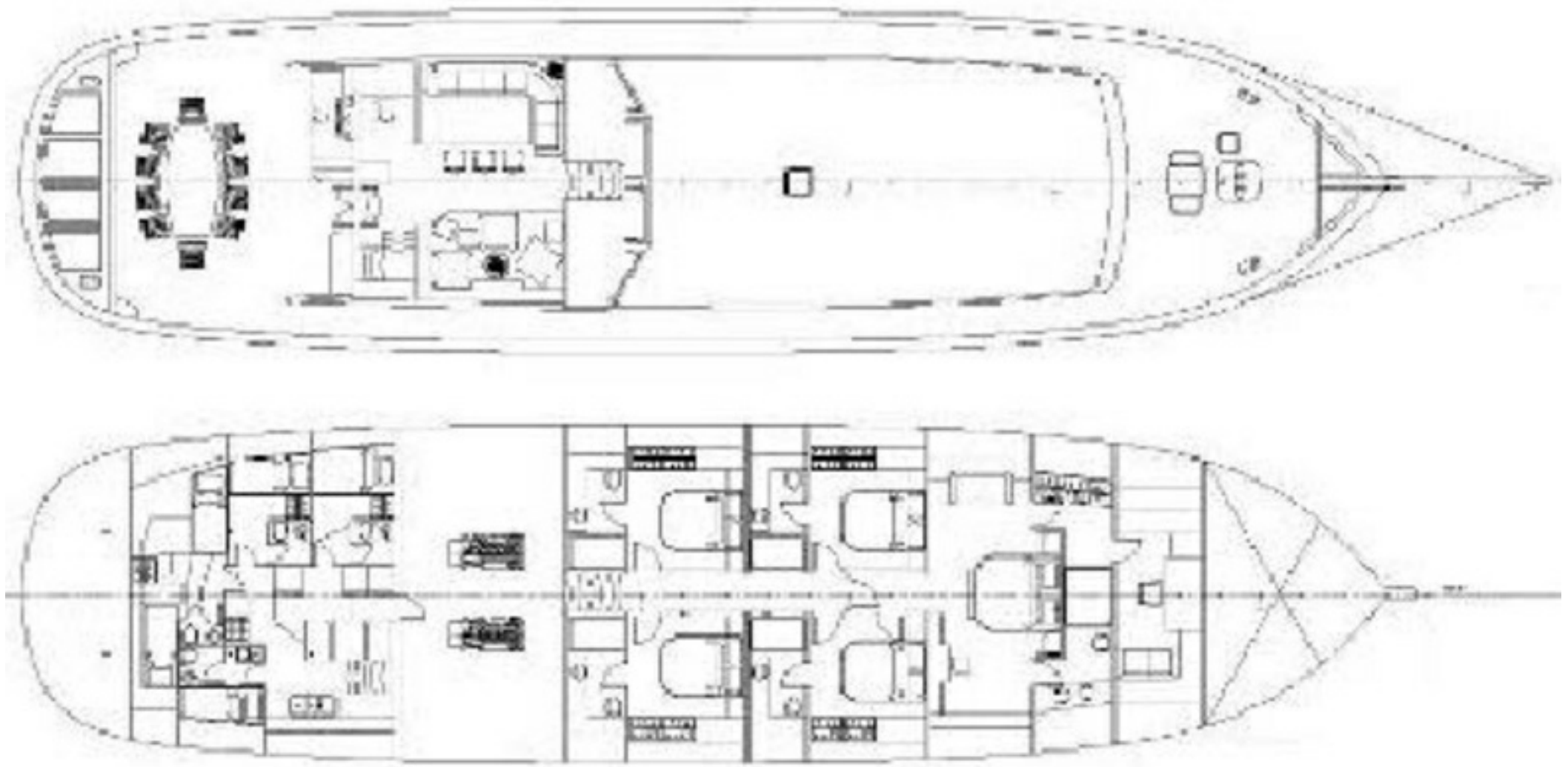

.COM

PLEASE CALL TO ENQUIRE:

HK Tel: +852 81 237 983 

UK Tel: +44 20 8123 0667 

USA Tel: +1 239 243 9678 

FOR MORE INFORMATION VISIT [SUPERYACHTS.COM](https://www.superyachts.com)

PAPA JOE

33.80m (110'10"ft) | 2007



PLEASE CALL TO ENQUIRE:

HK Tel: +852 81 237 983 

UK Tel: +44 20 8123 0667 

USA Tel: +1 239 243 9678 

FOR MORE INFORMATION VISIT SUPERYACHTS.COM

PAPA JOE

33.80m (110'10"ft) | 2007

SPECIFICATIONS

Overview

Name:	Papa Joe
Type:	Sail Yacht
Model:	Custom
Sub Type:	
Builder:	Mastori Yachts
Naval Architect:	
Exterior Designers:	
Interior Designer:	
Year:	2007
Flag:	Turkish
MCA:	
Class:	-
Hull NB:	-
Hull Colour:	-

Dimensions

Length Overall:	33.80m (110'10"ft)
Length at Waterline:	-
Beam:	8.20m (26'10"ft)
Draft (min):	-
Draft (max):	4.80m (15'8"ft)
Gross Tonnage:	-

Accommodations

Guests:	10
Cabins Total:	5
Cabins:	-
Crew:	6

Construction

Hull Configuration:	-
Hull Material:	-
Superstructure:	-
Deck Material:	-
Decks NB:	-

Engine(s)

Quantity:	2
Fuel Type:	-
Manufacturer:	MAN
Model:	2866LXE
Power:	440hp / 328kW
Total Power:	880hp / 656kW
Propulsion:	-

Performance & Capabilities

Max Speed:	13.00 kts
Cruising Speed:	12.00 kts
Range:	-
Fuel Capacity:	-
Water Capacity:	-

Equipment

Generator:	-
Stabilizers:	-
Thrusters:	-
Amenities:	-

PLEASE CALL TO ENQUIRE:

HK Tel: +852 81 237 983 
UK Tel: +44 20 8123 0667 
USA Tel: +1 239 243 9678 

FOR MORE INFORMATION VISIT [SUPERYACHTS.COM](https://www.superyachts.com)