

AVAILABLE FOR
CHARTER



Sunday

58.60m (192'3"ft) | Benetti | 2006

Charter M/Y Sunday

Sunday is a 59 metre motor yacht which was built and launched by the Italian yacht builder Benetti in 2006. She features naval architecture also by Benetti, exterior design by Stefano Natucci and interior styling by Studio Ipso.

Weekly Charter Rates

Summer

From 300 000 €

Winter

From 300 000 €

Details correct as of 03 Apr, 2019

FOR CHARTER

Cabins: -
Guests: 12
Crew: 15
Beam: 10.00m (32'9"ft)
Draft: 3.10m (10'2"ft)
Speed: 15.00 kts
Built/Refit: 2006

View online at

<http://www.superyachts.com/yacht-charter/sunday-2412/>

PLEASE CALL TO ENQUIRE:

HK Tel: +852 81 237 983 
UK Tel: +44 20 8123 0667 
USA Tel: +1 239 243 9678 

FOR MORE INFORMATION VISIT [SUPERYACHTS.COM](http://www.SUPERYACHTS.COM)

SUNDAY

58.60m (192'3"ft) | 2006

ACCOMMODATION

Sunday can sleep up to a maximum of twelve guests in her luxury six stateroom layout which features a master suite, VIP suite and four guest staterooms. She also fully accommodates for her crew in separate crew quarters ensuring a relaxed and luxurious charter experience.

TENDER & TOYS

1 x Novurania Custom Tender with 430 x
1 x 18.04ft /5.5m Novurania Custom Tender with 115 x
1 x Zodiac Tender
2 x Jet-Skis
1 x Canoe bottom plastic
Towable Toys
Inflatable water toys
Banana
Water-Ski
Wet suit
Fishing Equipment

AMENITIES

Air Conditioning
WiFi connection on board
Deck Jacuzzi

PLEASE CALL TO ENQUIRE:

HK Tel: +852 81 237 983 
UK Tel: +44 20 8123 0667 
USA Tel: +1 239 243 9678 

FOR MORE INFORMATION VISIT [SUPERYACHTS.COM](https://www.superyachts.com)

SUNDAY

58.60m (192'3"ft) | 2006

YACHT LAYOUT



Lower Deck



Main Deck

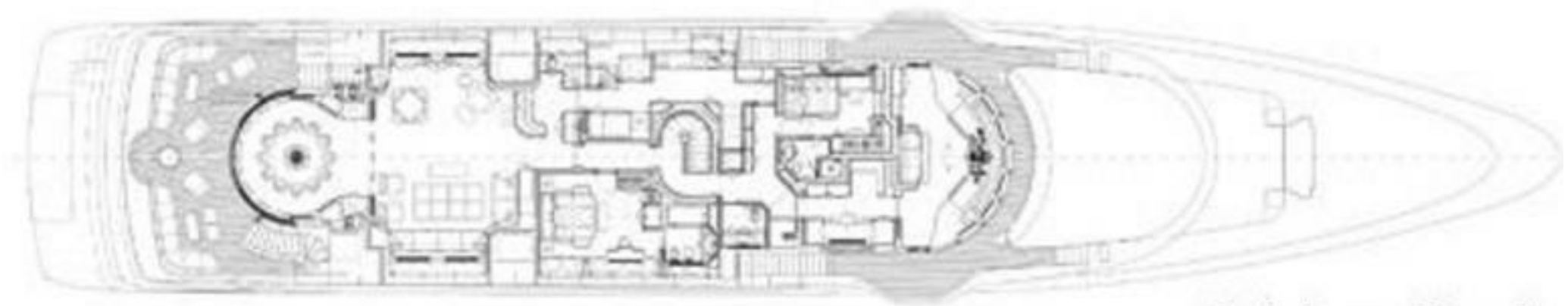

Bridge Deck

.COM

PLEASE CALL TO ENQUIRE:

HK Tel: +852 81 237 983 

UK Tel: +44 20 8123 0667 

USA Tel: +1 239 243 9678 

FOR MORE INFORMATION VISIT [SUPERYACHTS.COM](https://www.superyachts.com)

SUNDAY

58.60m (192'3"ft) | 2006



PLEASE CALL TO ENQUIRE:

HK Tel: +852 81 237 983 
UK Tel: +44 20 8123 0667 
USA Tel: +1 239 243 9678 

FOR MORE INFORMATION VISIT SUPERYACHTS.COM

SUNDAY

58.60m (192'3"ft) | 2006



PLEASE CALL TO ENQUIRE:

HK Tel: +852 81 237 983 
UK Tel: +44 20 8123 0667 
USA Tel: +1 239 243 9678 

FOR MORE INFORMATION VISIT SUPERYACHTS.COM

SUNDAY

58.60m (192'3"ft) | 2006



PLEASE CALL TO ENQUIRE:

HK Tel: +852 81 237 983 

UK Tel: +44 20 8123 0667 

USA Tel: +1 239 243 9678 

FOR MORE INFORMATION VISIT [SUPERYACHTS.COM](https://www.superyachts.com)

SUNDAY

58.60m (192'3"ft) | 2006

SPECIFICATIONS

Overview

Name:	Sunday
Type:	Motor Yacht
Model:	Custom
Sub Type:	
Builder:	Benetti
Naval Architect:	Benetti
Exterior Designers:	Stefano Natucci
Interior Designer:	Studio Ipso
Year:	2006
Flag:	st vincent
MCA:	Yes
Class:	-
Hull NB:	FB 235
Hull Colour:	-

Dimensions

Length Overall:	58.60m (192'3"ft)
Length at Waterline:	50.10m (164'4"ft)
Beam:	10.00m (32'9"ft)
Draft (min):	0.00m (0'ft)
Draft (max):	3.10m (10'2"ft)
Gross Tonnage:	748 tonnes

Accommodations

Guests:	12
Cabins Total:	-
Cabins:	-
Crew:	15

Construction

Hull Configuration:	-
Hull Material:	Steel
Superstructure:	Aluminium
Deck Material:	-
Decks NB:	-

Engine(s)

Quantity:	2
Fuel Type:	Diesel
Manufacturer:	Caterpillar
Model:	-
Power:	1850hp / 1380kW
Total Power:	3700hp / 2760kW
Propulsion:	Twin Screw

Performance & Capabilities

Max Speed:	16.00 kts
Cruising Speed:	15.00 kts
Range:	5000.00 miles at 12 kts
Fuel Capacity:	130,000.00 L / 28,595.97 USG
Water Capacity:	20,000.00 L / 4,399.38 USG

Equipment

Generator:	3 x Caterpillar 162 kW
Stabilizers:	-
Thrusters:	-
Amenities:	-

PLEASE CALL TO ENQUIRE:

HK Tel: +852 81 237 983 
UK Tel: +44 20 8123 0667 
USA Tel: +1 239 243 9678 

FOR MORE INFORMATION VISIT [SUPERYACHTS.COM](https://www.superyachts.com)